

# J (LOGIC 5.0) JACKSHAFT OPERATOR

SECTION 08 71 13



## KEY FEATURES

### STANDARD APPLICATION

Recommended for lighter rolling steel doors/grilles and high or vertical-lift sectional overhead doors in standard duty-cycle commercial applications where a manual hoist is not required

### RATED DUTY CYCLE

Standard-duty: Up to 25 cycles/hour and up to 90 cycles/day (using continuous-rated motor)

### OPERATOR SPEED

8-9 Inches per second

### LIMIT SETTINGS

Mechanical

### EMERGENCY DISCONNECT FOR MANUAL OPERATION

Floor-level emergency release sash chain

### EMERGENCY DISCONNECT WITH AUTO-RECONNECT

Reconnects when tension is removed from emergency release sash chain

### PROGRAMMING

Control function selector dial/tactile button

### CIRCUIT BOARD

Solid-state Logic 5.0 circuit board

### TIMER-TO-CLOSE

Programmable in 1 second and 15 second increments up to 68 minutes, standard

### CLUTCH

Standard adjustable friction clutch

### MID-STOP

Programmable

### RUN TIME PROTECTION

Maximum run timer

### MOTOR REVERSE ACTION PROTECTION

Delay-on-reverse circuit

### MOTOR OPERATOR WALL CONTROL

3-Button Control Station with Maintenance Alert System (MAS)

### PUSH BUTTON STATION

3-Push button station (Open/Close/Stop)

## SPECIFICATIONS

### RADIO RECEIVER

Security+ 2.0® technology standard on-board with tri-band frequency; accepts up to (90) single-button or (30) 3-button remote controls plus up to (30) wireless keypads or an unlimited number of DIP switch remotes

### VOLTAGE CONNECTIONS

Single-phase: 115V/230V dual voltage; 3-phase: 208V/230V/460V dual voltage; 3-phase: 575V single voltage  
5VDC NEC class 2

### CONTROL CIRCUIT

### DRIVE REDUCTION

Belt/chain & pulley; first-stage heavy-duty 5L V-belt; second-third-fourth stages #48 chain; #50 output sprocket chain

### BEARINGS/BUSHINGS

Industrial ball bearings on a 1" output shaft; heavy-duty oil-filled bushings on reduction shafts

### BRAKE

Standard on 3/4 and 1 HP operators; optional on 1/2 HP; not available on 1/3 HP

### CONSTRUCTION

NEMA 1 type electrical box; heavy-duty 11-gauge steel frame with durable powder coat finish; all reduction sprockets drilled and pinned to shafts

### WARRANTY

2 years

## INSTALLATION FEATURES

### UNIVERSAL MOUNTING

Yes

### MAXIMUM DOOR HEIGHT

26 feet standard with additional capability\*

### MAXIMUM DOOR WIDTH

22 feet standard with additional capability\*

### MAXIMUM ALLOWABLE SQUARE FOOTAGE

640 square feet

### INTERNET CONNECTIVITY

myQ® Technology enables remote monitoring and control of the commercial door via a smart phone, tablet, or computer\*\*

This commercial door operator must feature constant pressure to close or be equipped with an external monitored entrapment protection device. Use only LiftMaster monitored entrapment protection devices itemized on the accessory page of the operators installation manual to meet UL 325 requirements.

\* Contact us at [Specs@LiftMaster.com](mailto:Specs@LiftMaster.com) for additional capabilities.

\*\*LiftMaster Internet Gateway and myQ app required.

# J (LOGIC 5.0) JACKSHAFT OPERATOR

SECTION 08 71 13

## DIMENSIONS

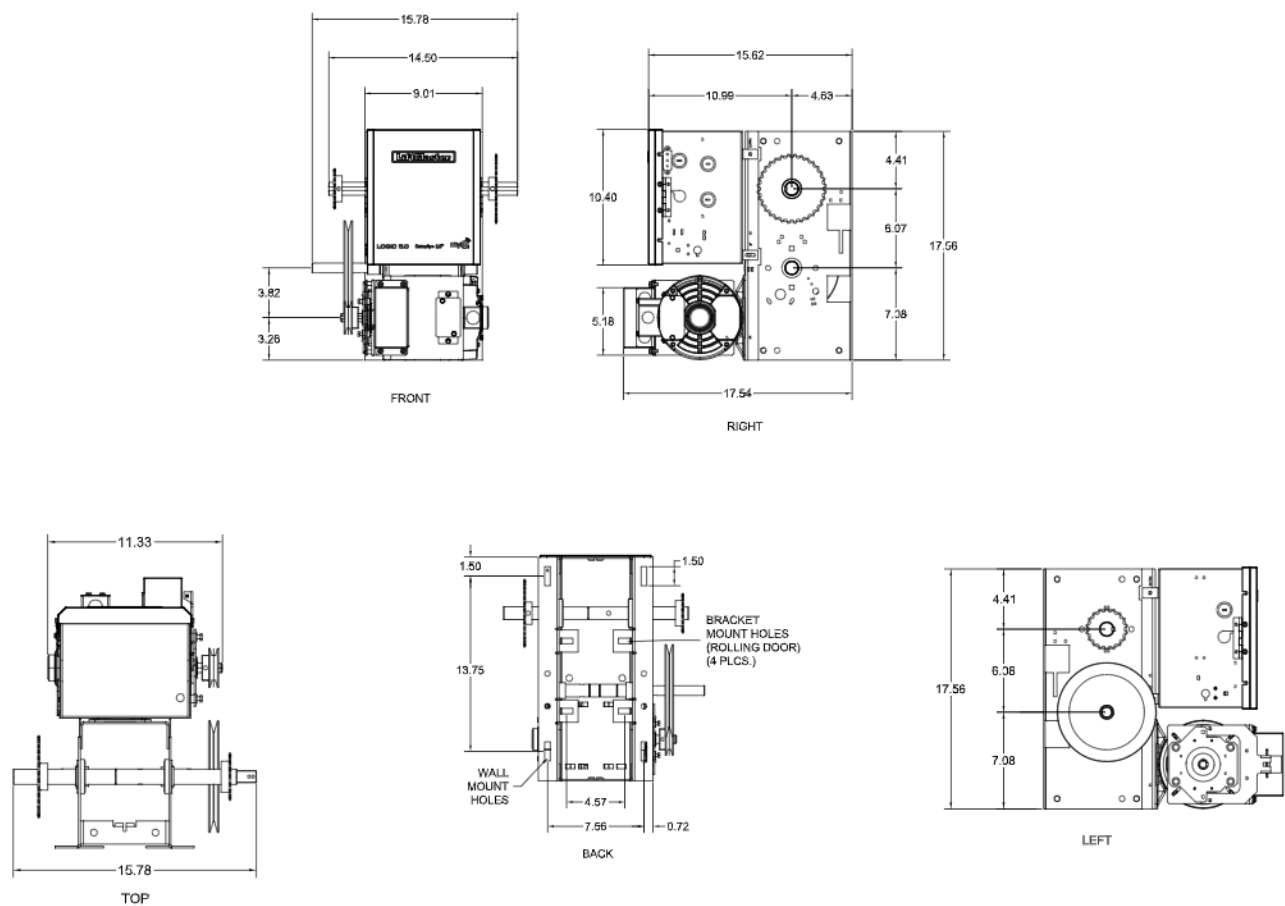

## CAPACITY

MAXIMUM DOOR AREA (SQ. FT.)						
ROLLING	24 ga. Steel	22 ga. Steel	—	20 ga. 18 ga. Steel	16 ga. Steel	—
	Aluminum Grilles	Aluminum Doors	—	Steel Grilles	—	—
SECTIONAL	—	24 ga. 22 ga. Steel	20 ga. Steel	—	16 ga. Steel	—
	Fiberglass	Aluminum Doors	Wood Doors	—	—	—
	—	—	24 ga. Steel Insulated	—	20 ga. Steel Insulated	16 ga. Steel Insulated
HP	1/3	310	285	260	210	175
	1/2	400	350	320	280	250
	3/4	560	500	450	380	325
	1	640	625	560	475	400

On steel insulated doors, a 24-gauge back panel is assumed.  
If a heavier back panel is supplied, use the next higher HP rating.  
Recommended max duty cycles: 25 per hour, up to 90 per day.